

55-9906-CA-CM

V0

GEA Cob Led Uplight recessed

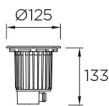

Description

Floor recessed for outdoor use.

For uplighting. Electronic components are in a sealed internal compartment, completely separate from the compartment where the connection terminals are located. The unit will withstand a static weight of 1,800 Kg and the occasional transit of slow-moving vehicles. Includes 2 anti-glare accessories. Includes 2 reflectors. Includes flush-mounting box. Suitable for installation in marine environments. Includes 2 cable outlets to facilitate chain mounting. Maximum light surface temperature below 40°C. Adjustable light source. Structure material: Stainless steel AISI316, High purity aluminium. Structure finish: Polished, Black. Diffuser material: Glass. Diffuser finish: Tempered. UV protection. Warranty: 5 Years.

Finish

Polished
Black
Tempered

Material

Stainless steel AISI316
High purity aluminium
Glass

IP65/IP67 IK10 15° ±15° 360° 8

TECHNICAL CHARACTERISTICS

Light source

Light source: LED CREE
Output (W): 9W
Total power consumption (W): 10.5 W
Color temperature: Neutral white - 4000K
CRI: 80
Photobiological risk: RG2
Real Lumen: 934
Qty Leds: 1
Lm/Real W: 89
Life Time: 60.000h L80B20
Bin / Grup: 40H
MacAdam steps: 2
UGR: 9.4

GEAR

Brand: EAGLERISE
Gear included: Yes, electronic
Voltage / Frequency: 100-240 VAC
Power Factor: 0.92
Flickering: 2.8%

Luminaire

Temperature on the surface: 40.00
Double cable exit: Yes
Drainage: Yes
Recessed: Si
Public Areas: 2000
Seaside: Yes
Uv Protection: Yes
Warranty: 5 Years

Logistics

Energy Efficiency: LED A++
EAN Code: 8435381439965
Net Weight (Kg): 1.025
Weight in Kg (packaged): 1.144
Packing: 130 x 130 x 140
Masterbox: 8

The photograph may not match the reference exactly. Please read the product description to identify the finish.

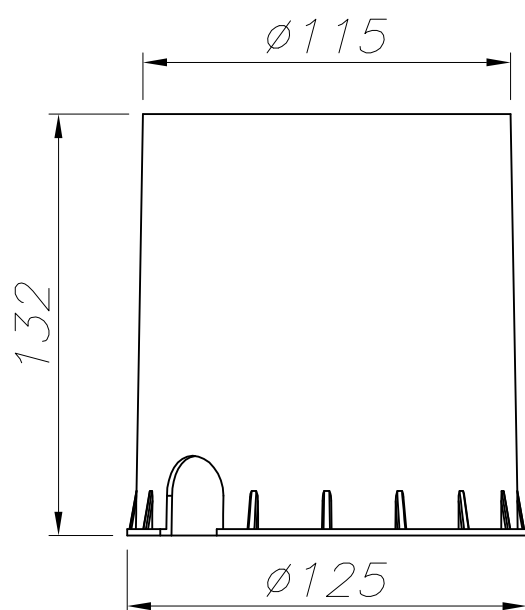
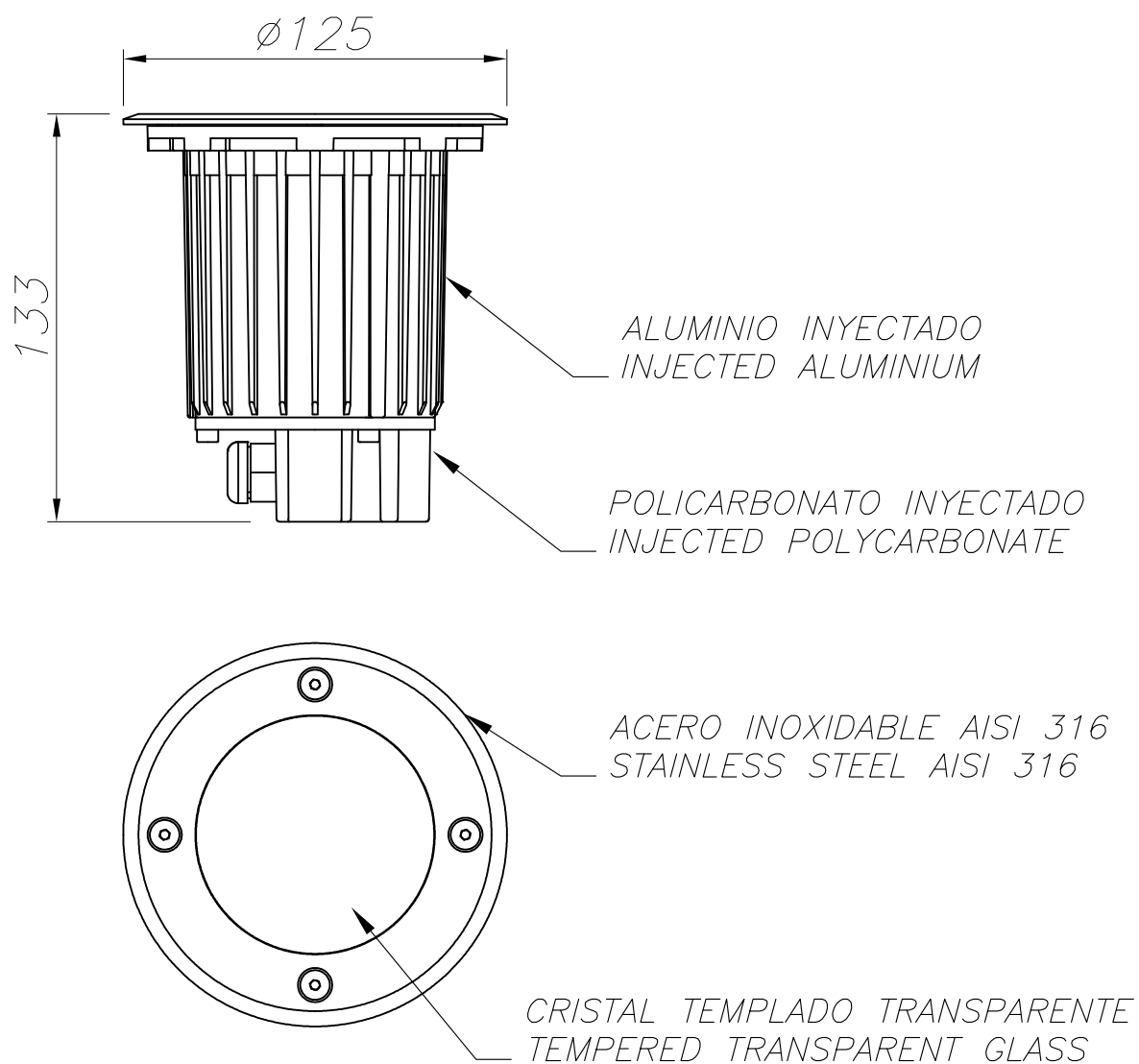

CAJA DE EMPOTRAR
FLUSH FITTING BOX

